

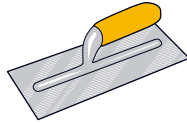

# Skim Plaster



## READY MIXED HEMP LIME ECOPLASTER TECHNICAL DATA SHEET

HEMPIRE™ Skim Plaster is a unique ready to use plaster made from finely chopped stem and fibres of the industrial hemp plant and reacted with lime and pozzolan in a novel process. It has been specifically designed to float over Hempire Building Plaster to give a perfectly smooth finish but Hempire Skim can also be applied on other substrates.

**NO ON-SITE MIXING/  
PREPARATION REQUIRED**

**CAN BE APPLIED TO  
WALLS THAT ARE  
STILL DAMP**

**BREATHABLE**

**GOOD FLEXIBILITY AND  
ABILITY TO SELF-HEAL**

**CONTRIBUTES TO  
LOWERING CO2  
EMISSIONS**

**LOW SLUMP**

**LOW RISK OF  
CRACKING AND  
SHRINKAGE**

---

### Performance

Studies have shown that for a typical house, for each square metre of walling constructed, up to 200kgs of CO<sub>2</sub> are emitted implying that up to 40 tonnes of CO<sub>2</sub> can be released just in the construction of the walls of a typical UK home. The builder using HEMPIRE™ Building Plaster, finished with Hempire Skim plaster instead of conventional materials to finish internal and external walls would make a significant contribution to combating global warming by reducing the amount of CO<sub>2</sub> released into the atmosphere. Furthermore, the additional thermal insulation of the plaster makes the building more energy efficient and hence reduces operating/utility expenses. In summer the plaster's unique properties help keep the building cool and comfortable reducing the need for air conditioning.

---

### Characteristics

<b>APPLICATION</b>	The plaster is suitable for finish coats of plaster internally and externally
<b>SHelf LIFE</b>	Product should ideally be used within 3 months of purchase
<b>COVERAGE</b>	20kg covers approximately 16m <sup>2</sup> if applied at a thickness of 1mm 20kg covers approximately 5.3m <sup>2</sup> if applied at a thickness of 3mm.
<b>CONTAINERS</b>	20kg bags and 1000kg dumpy bags with plastic liners

---

### Handling, Storage & Disposal of Waste

This product has high pH of 12.4 so avoid contact with skin and eyes and use barrier cream if necessary. In case of contact with eyes or skin wash affected area with plenty of clean running water and seek medical advice if any discomfort persists. The packaging is sufficient to protect the product but once opened the product should be protected from getting wet or from starting to dry. Empty packaging and residues of the plaster must be disposed of in accordance with current local and national legislation at licensed waste facilities

# PROVISIONAL RESULTS

Our results are to be confirmed by independent testing at the Building Research Establishment (BRE) and the Civil Engineering Department of the University of Kingston in Surrey, results due late 2008

---

## Working Characteristics

Hempire™ Skim Plaster has been formulated for ease of application, but we are aware that different plasterers appreciate different levels of workability, so we have given it a consistency that may be a little bit dryer than some plasterers would like (on the basis that it is easier to add some water than to take it out). If a wetter consistency is preferred additional water can be added and mixed into the plaster, but care should be taken not to make the plaster too wet as this could lead to cracking or dusting as the plaster dries out. In dry, warm weather dampen the walls to avoid the plaster drying too quickly and cracking. The plaster incorporates natural hemp fibres there is a limited but intrinsic variability in working characteristics. HEMPIRE™ Skim Plaster is manufactured to a high quality standard aimed at ensuring products are as consistent as possible. Minor variations in working characteristics are normal, and should not be the cause of concern.

---

## Drying Time

Dependent on the substrate, thickness of application and ambient conditions, drying time of the plaster is typically less than 4 hours.

---

## Porosity

Once fully dried, the porosity is typically in the range of 55-60% depending on drying conditions and thickness. This imparts an improved insulation & acoustic isolation properties! It also allows the plastered finish to absorb atmospheric moisture when humidity is high, and release it when the air is dry. Hempire Building Plaster helps regulate ambient air quality, and imparts a nice warm feel to the plaster.

---

## Fire Resistance

Tests indicate that plaster surfaces exposed to direct flame will char but will not sustain the flames once the direct source is removed. Formal fire testing is planned at the BRE.

---

## Water Resistance

Hardening takes place through accelerated carbonation of the lime component of the plaster and as a result the plaster will remain hard even when wet.

---

## Compatibility

In addition to its normal use with Hempire Building Plaster it can be used as finishing coat to a range of plasters, giving a smooth finish with the assurance of interlocking hemp fibres giving a durable attractive finish. However the insulating properties and breathability will depend on the qualities of the substrate plaster used.

### NORTHERN IRELAND OFFICE

Hempire Building Products  
89 Dowland Road  
Drenagh Limavady  
N. Ireland BT49 0HR

Tel +44 (0) 28 7776 9794  
Fax +44 (0) 28 7776 5637

### REPUBLIC OF IRELAND OFFICE

Hempire Building Products  
Burdautien, Clones  
Co. Monaghan  
Ireland

Tel + 353 (0) 47 52049  
Fax + 353 (0) 47 52295

